

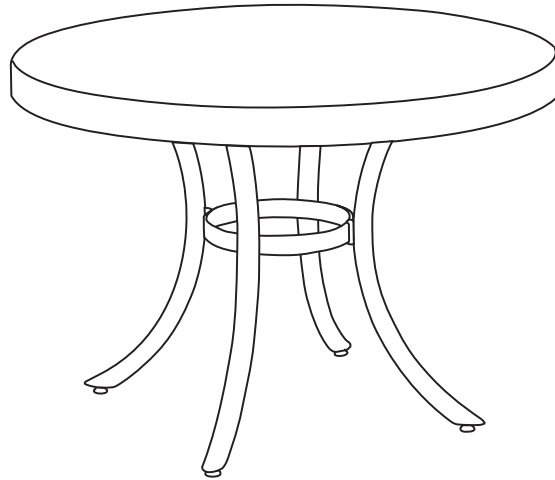

ASSEMBLY SCHEMA OSAKA Ø 110 Alu. Base



Website



Contents

a) 1pc. Ø110 Table Top

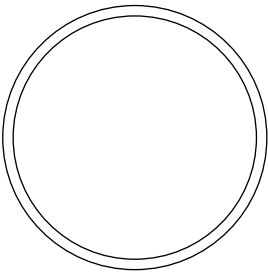

b) 1set Table Base

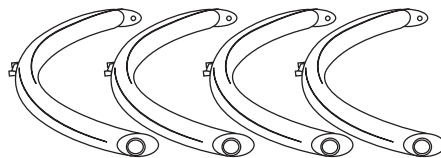

c) 1pc. Middle Circle

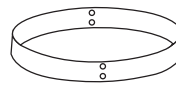

e) 4 ad. M4,8x32 YHB Screw



d) 8pcs. M6x25 HB Screw



f) 4 pcs. Pingo

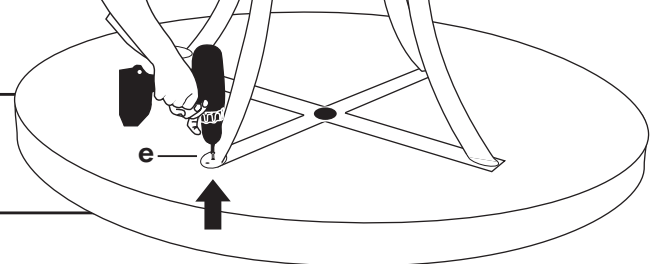
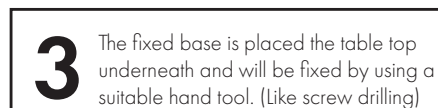
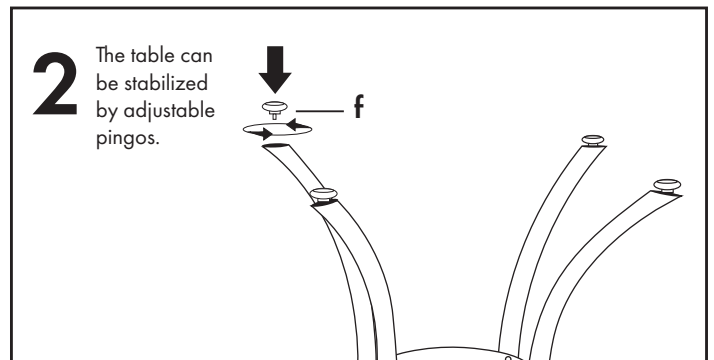
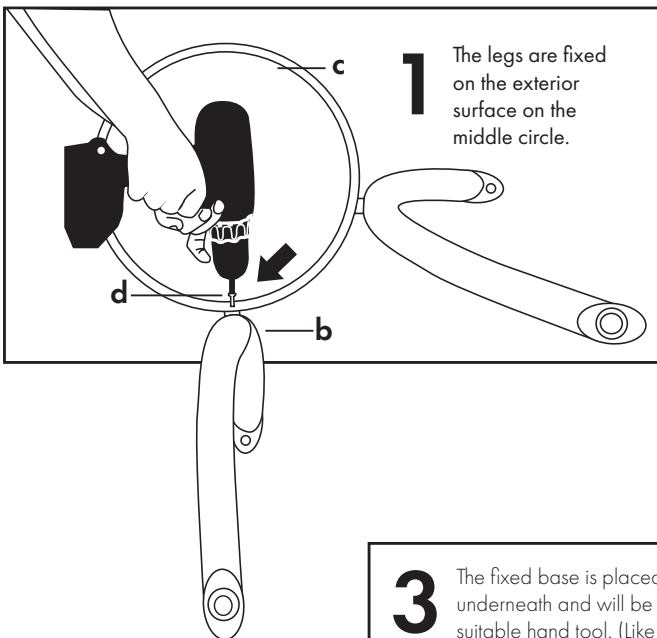

! Please be sure not to miss any screw holes and fasten all screws equally and tightly. Otherwise, you may face with breakage or cracking during the time of usage.

Tilia

KURULUM ŐEMASI OSAKA Ø 110 Alü. Ayak



Website

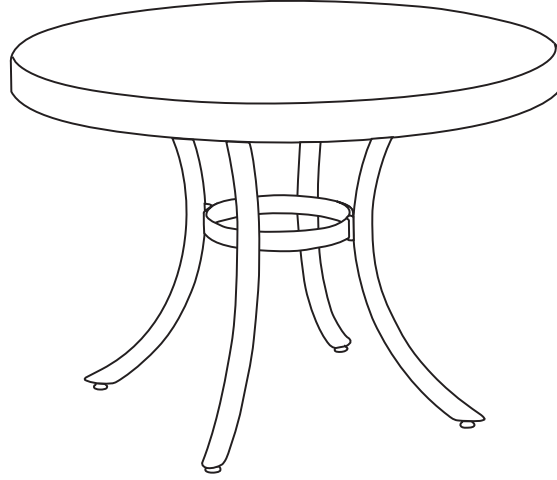

İçerik

a) 1 ad. Ø110 Tabla

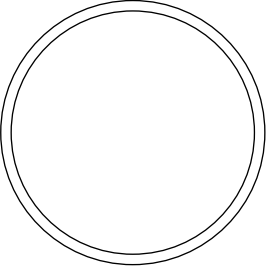

b) 1tk. Ayak Seti

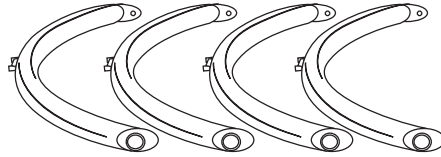

c) 1 ad. Orta Halka

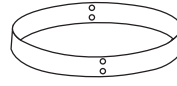

e) 4 ad. M4,8x32 YHB Vida



d) 8 pcs. M6x25 HB Vida



f) 4 pcs. Pingo

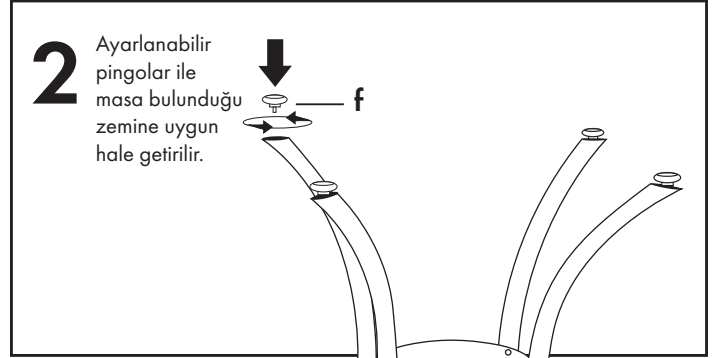
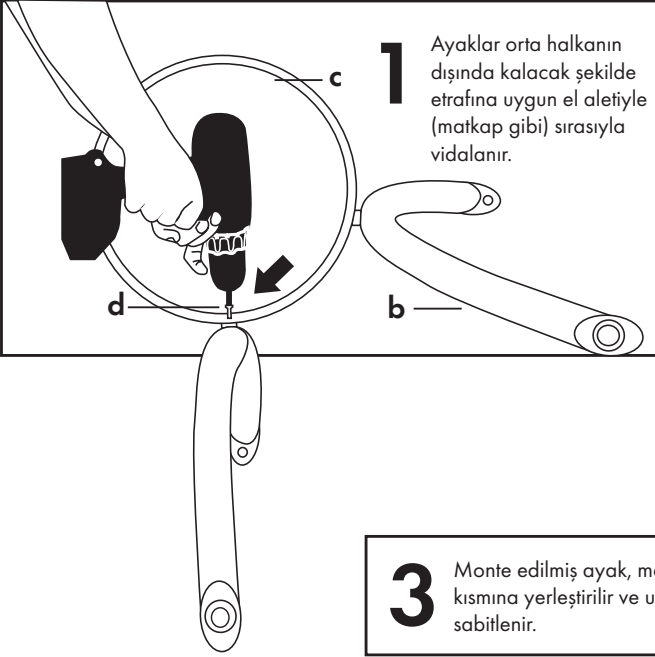

3 Monte edilmiş ayak, masa tablasının alt kısmına yerleştirilir ve uygun el aletiyle sabitlenir.

4 Cam yüzey varsa tüm işlemler bittikten sonra masanın üzerine yerleştirilir.

a

! Lütfen montajınızı yaparken vida deliklerini atlamamaya, vidaların tam ve sıkı olduğuna emin olunuz. Aksi halde ürünün kullanımı sırasında kırılma/çatlama ile karşılaşabilirsiniz.