



# ASSEMBLY SCHEMA

## Eos

Chair/Bar Chair  
(Metal Leg)

### Contents

a) 1 pc. Shell

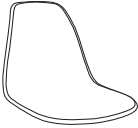

b) 4 pcs. Nuts



c) 1 pc. Leg

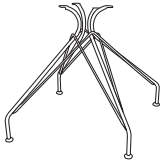

X LEG

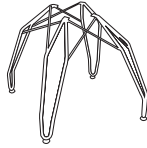

M LEG



X BAR LEG



M BAR LEG

**1** Place the chair leg (c) under the seat part, match "X" symbols. Pass the holes of the seat legs to the screws under the seat.

**2** Attach the nuts (b) to the screws available under the seat.

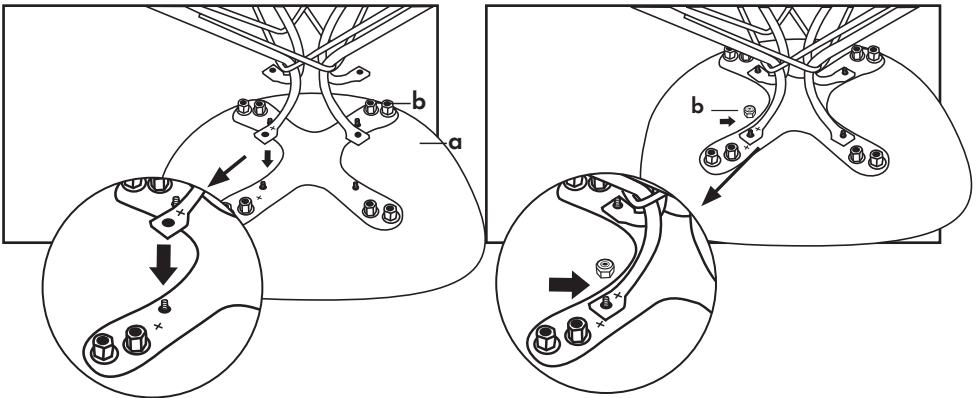

**!** Please be sure not to miss any screw holes and fasten all screws equally and tightly. Otherwise, you may face breakage or cracking during the time of usage.

# Tilia

## KURULUM ŞEMASI

### Eos

Sandalye/Bar Sandalyesi  
(Metal Ayak)

İçerik

a) 1 ad. Kabuk

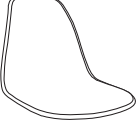

b) 4 ad. Somun



c) 1 ad. Ayak

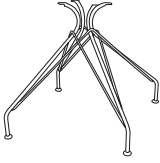

X AYAK



M AYAK



X BAR AYAK



M BAR AYAK

**1** Kabuk(a) uygun bir zemine ters şekilde yerleştirilir. Ayak(b) ve kabuk üzerinde bulunan "X" işaretleri hizalanarak ayak, kabuktaki vidalara oturtulur.

**2** Ayak(b), fiberli somun ile uygun el aleti kullanılarak (matkap/alyan) kabuğa sabitlenir.

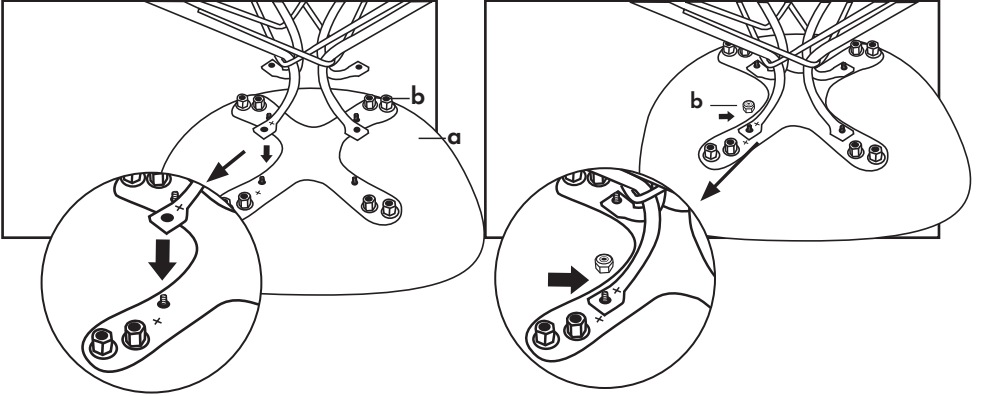

! Lütfen montajınızı yaparken vida deliklerini atlamamaya, vidaların tam ve sıkı olduğuna emin olunuz. Aksi halde ürünün kullanımı sırasında kırılma/çatlama ile karşılaşabilirsiniz.